

Battery Powered Photoelectric Smoke Alarm User Manual

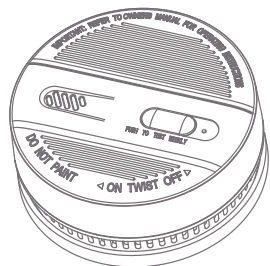

Model: FASD2

PRODUCT INTRODUCTION

This product is a battery operated photoelectric smoke alarm, adopting unique structure design and advanced photoelectric sensor technology, able to monitor and detect smoke particles in real time, especially detects visible particles (associated with smouldering fire) faster than ionization alarms. Once smoke particles or a fire danger is detected, this alarm will chirp and the red LED will flash rapidly to alert you and your family timely. Furthermore, this alarm has the functions of dust-proof, insect guards, anti-light interference, ensuring stability from design and suitable for indoor places such as residences, factories, shopping malls, hotels, etc.

PRODUCT PROFILE

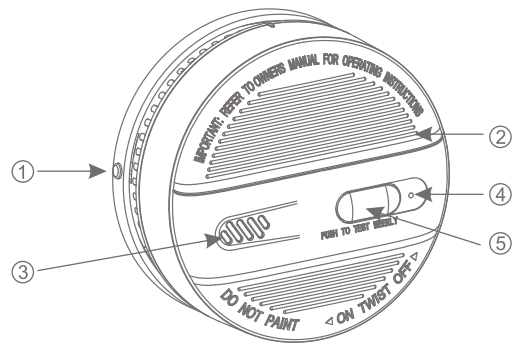

- 1 Tamper-Resist Locking Pin.
- 2 Battery Compartment Cover.
- 3 Buzzer.
- 4 LED Indicator.
- 5 Test/Hush Button.

TECHNICAL SPECIFICATION

Working Voltage: DC 9V (6F22 / 6LR61 battery)
Battery Life: 1 year (carbon zinc 6F22 battery)
5 years (alkaline 6LR61 battery)
Sound Level: ≥ 85dB (at 3m straight ahead)
Sensor Type: Photoelectric
Battery Life After Low Battery Warning: > 30 days
Working Temperature: 0° C ~ +55°C
Working Humidity: ≤ 95%RH (no condensation)
Dimensions:Φ95.6 x 43.2mm
Detecting Area: 80m² at 6-12m installation height
60m² at installation height < 6m

FEATURES

- Advanced photoelectric sensing technology, detects visible particles (associated with smouldering fire) faster than ionization alarms.
- Convenient to install and maintain.
- Battery compartment on alarm top surface, battery replacement is more convenient and has protection function for reverse battery loading.
- Low battery warning, smoke alarm will chirp once every 56s to remind user of replacing a new battery.
- Auto- reset.
- Sound and flash alarm , alarm sound louder than 85 decibel with red LED flashing.
- Test button, tests unit's electronic circuitry, buzzer and battery function.
- SMT manufacture technology, high stability.
- Dustproof, insect guards and anti-white light interference design.
- Anti-RFI.

INSTALLATION

1. Avoid installations in places with stagnating smoke, heavy dust, heavy water mist, heavy oil mist, great humidity (>95%) and high wind speed (>5m/s).
2. Insert the battery correctly into the battery compartment according to the marked positive and negative polarity.
3. Choose a proper position. Normally the center of the detection area ceiling is recommended. If impractical, do not install the detector in area without air flow (as Figure 1). For roof with oblique beam, the ceiling is also oblique where the detector should be installed at a position with 0.9m horizontal distance to spire (as Figure 2). Fix the detector base into a chosen position with screws. Then put the detector head into the base and twist clockwise to fasten it (as Figure 3). At last, plug in the tamper resist locking pin (as Figure 4).

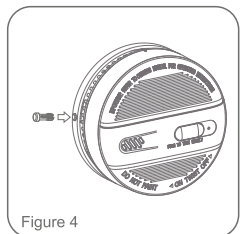
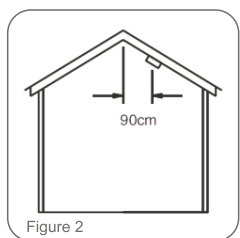
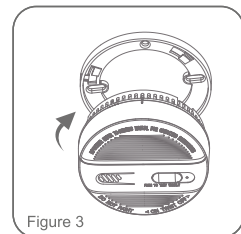
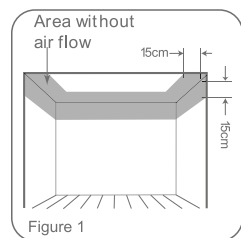

OPERATING INSTRUCTION

1. Battery is equipped on delivery. Unpack the battery insulation package to active the battery before using.
 2. After activating the battery, the smoke alarm enters into normal monitoring status. The LED blinks once every 56s.
 3. Test the smoke alarm device.
- WARNING!**
- Test each smoke alarm device to be sure it is installed correctly and operating properly.
 - The test button accurately tests all functions. DO NOT use an open flame to test this smoke alarm device. You may ignite and damage the smoke alarm device or your home.
 - Test smoke alarm devices monthly and upon returning from vacation when no one has been in the household for several days.
 - Stand at arm's length from the smoke alarm device when testing. The alarm horn is loud to alert you to an emergency and can be harmful to hearing.

- Press and release the test button to test the alarm. The alarm will sound loud short beeps. The alarm may stop sounding once releasing the test button.
4. Hush function
- The alarm features a False Alarm Control that, when activated, silences unwanted alarms for up to 10 minutes.
- To use the False Alarm Control:
- Press and release the test button during an unwanted alarm to silence the alarm horn. This means the smoke alarm device is in False Alarm Control. If the smoke alarm device does not go into False Alarm Control and continues to sound its loud alarm horn or if it initially goes into False Alarm Control then resounds the alarm, which indicates there may be heavy smoke or fire dangers, the user should take emergency actions ASAP.
5. Battery Replacement
- When smoke alarms have low battery warning, please replace the battery immediately (as Figure 5). During replacement, mind the positive and negative polarity markings and use 9V batteries. Using improper battery may cause damage to the alarm.

WHENEVER THE BATTERY IS REPLACED, TEST THE ALARM FOR CORRECT OPERATION BY PUSHING THE TEST BUTTON.

Push and hold Test&Hush button for more than one second, smoke alarm should sound its alarm horn and red LED flashes if battery is fitted correctly.

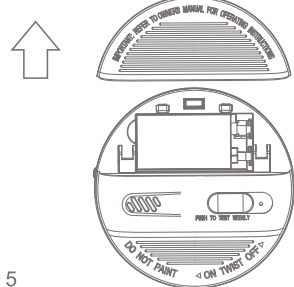

Figure 5

6. Visual And Audible Indications

CONDITION	LED	HORN
Normal Operation	Red LED flashes once every 56 seconds.	None
Test Condition	Red LED flashes rapidly.	Short quick beeps
Alarm Condition	Red LED flashes rapidly.	Short quick beeps
Low Battery	Red LED flashes every 56 seconds.	One beep every 56 seconds
Malfunction	Red LED flashes twice every 56 seconds.	Two beeps every 56 seconds
Local Hush for alarm condition	Red LED flashes once every 10 seconds.	None(Duration: about 10 minutes)
Local Hush for low battery alarm	Red LED flashes once every 56 seconds.	None(Duration: about 12 hours)
Local Hush for malfunction	Red LED flashes twice every 56 seconds.	None(Duration: about 12 hours)

NOTICE

1. The malfunction auto check function of this smoke alarm only provides infrared photoelectric sensor malfunction check and low battery power check. The sensor sensitivity should be tested periodically as required.
2. To ensure the sensitivity to smoke, clean the smoke alarm surface with soft brush or clean every 6 months. Do not use solvent, liquid or detergent to clean the smoke alarm.
3. For malfunction problems, please contact with vendor on time. Do not dismantle and try to repair alarms privately.
4. If smoke alarms are not used for a long time, dismount them, remove batteries, put them in packing box and store in cool place.
5. Photoelectric smoke alarms could reduce disaster happening. But they can not guarantee a hundred percent safety. For your safety concern, please use this smoke alarm correctly and know the fire safety tips. In daily life, pay attention to build up safety consciousness and take preventive measures.

FIRE SAFETY TIPS

Follow fire safety rules and prevent hazardous situations:

1. Store combustible liquids such as gasoline in proper containers.
2. Never smoke in bed. After smoking a cigarette, put it out and place in a correct container.
3. Check if power sockets, plugs or switches are broken. If cables are frayed or cracked replace them on time.
4. Using power electric appliances such as heaters or heating equipments, do not make the circuit overload and check periodically if these appliances work properly.
5. Keep portable heaters and open flames, like candles, away from flammable materials.
6. Keep matches or lighters away from children.
7. Keep at least one working fire extinguisher on every floor and an additional one in the kitchen. Have fire escape ladders or other reliable means of escape from an upper floor in case stairs are blocked.
8. Make sure all the family members know what to do after hearing an alarm signal.
9. Install smoke alarms correctly according to manual. Keep alarms clean and do not let dust accumulate and test them monthly. Replace them immediately if they are not working properly.