

User manual

FS1HT

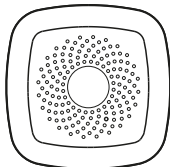

*Please read the user manual carefully before operation.



Product introduction

This product is a smart temperature and humidity detector, adopts extra low power consumption ZIGBEE wireless network technology, using MCU to the temperature and humidity intelligent processing, with functions of dust-proof, insect-sproof, etc. Ensuring the stability of the product from the design. With high precision temperature and humidity sensor built-in, it can perceive and report real-time temperature and humidity to APP. The product is suitable for environmental monitoring in residential, factory building, computer room, shopping mall, hotel, office building, teaching building, bank, library, as well as the warehouse and many other places.

2

1. Operating voltage: DC3V (1 CR2450 button battery);
2. Standby current: $\leq 10\mu A$
3. Networking way: ZigBee ad hoc network
4. Wireless networking distance: $\leq 100m$ (open area)
5. Operating temperature: $-15 \sim +60\text{ }^{\circ}\text{C}$;
6. Ambient humidity: Maximum 95%RH
7. Outline dimension: 60*60*20.8mm

3

4

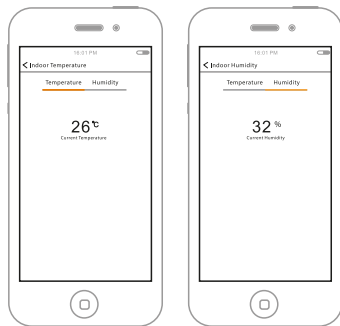

5

Adding device

Select the Smart Hub from the list of devices to which you want to add a new device (sensor) or device with factory settings restored.

1. Click add devices on APP, enter networking mode.



When the LED in the control panel blinks blue, we confirm and go to pairing devices.

6

3

2. According to the tips on APP, keep pressing networking button, green LED flash quickly, tips appear on APP, green LED keep on for 3 seconds, network success,

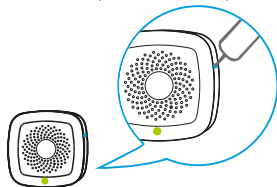

Delete device

In the application, click and hold the selected device, the "delete device" command will be displayed. After removed it, disconnect the network connection device by pressing and holding the pairing button. 6-fold LED blink in green means disconnection of the sensor network from the HUB.

7

4

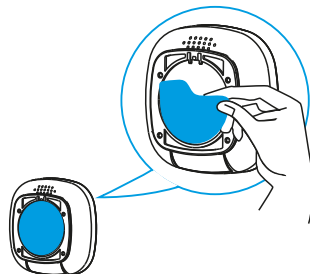

- Remove battery insulation film to power on.

1

2

8

9

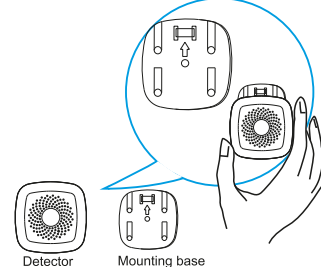

Detector

Mounting base

- Tear off the gummed film, stick the equipment in the required area.

- Note that the mounting base shall be up as the direction of arrow shown in the graph. Finally, hang the detector into the mounting base.

5

Download app: **Ferguson Smart**



* this device requires Ferguson Smart Hub unit to work, not included.

More info

www.ferguson-digital.eu

and

wiki.ferguson.pl/en

Thanks!

10

1. Ferguson Sp. z o.o. is not responsible for damages caused by improper use of the Ferguson Smart Home system.
2. Batteries attached to the device are not an integral part and not a subject to complaint. The manufacturer is not responsible for their proper operation.
3. Declared wireless ZigBee network's range is based on laboratory tests and applies to open space, keep in mind that the materials used in the construction of houses and flats, wall thickness and conditions of electromagnetic fields can cause a significant reduction in network coverage.



Your product contains batteries covered by the European Directive 2006/66/EC, which cannot be disposed with normal household waste. Please inform yourself about the local rules on separate collection of batteries because correct disposal helps to prevent negative consequences for the environmental and human health.



11

Safety

intelligent home solutions don't have to be expensive



12