

Motion Sensor User manual

FS1MS



*Please read the user manual carefully before operation.

Product Introduction

This product adopts super low power consumption ZIGBEE wireless network design and automatic threshold adjustment technology to enhance the stability of the detector, efficiently anti-false alarm. Automatic temperature compensation technology, can efficiently prevent detectors from the decrease in sensitivity resulted from the temperature variation. Suitable to be used for safety protection of residential, villas, factories, shopping malls, warehouses, office buildings, banks, computer room and other places.



2

1. Power Voltage: DC3V (1x CR 123 Battery)
2. Standby Current: $\leq 15\mu\text{A}$
3. Alarm Current: $\leq 30\text{mA}$
4. Detecting Angle: 90 degrees
5. Installation Height: 2.1 m
6. Detecting iDstance: 8-10 m
7. Working Temperature: $-10^{\circ}\text{C} \sim +50^{\circ}\text{C}$
8. Environment Humidity: $\leq 95\%\text{RH}$ (no congelation)
9. Networking Mode: ZigBee auto networking
10. Networking Distance: $\leq 100\text{ m}$ (in the open area)
11. Dimension: 65x65x28mm

3

4

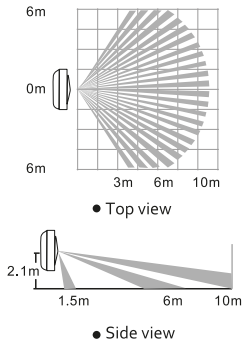

- Please avoid installation in outdoor, places with pets, air-condition, heat source nearby, places with direct sunshine and places under rotating objects.
- The installation surface should be solid without vibration.
- Please install the detector in places where an intruder may pass easily.



Tips

- Removing insulator make device on power. Device will in warm-up state when red LED flashes, after 30 seconds LED off, warm-up complete.

6

Adding device

Select the Smart Hub from the list of devices to which you want to add a new device (sensor) or device with factory settings restored.

1. Click add devices on APP, entering networking mode.



When the LED in the control panel blinks blue, we confirm and go to pairing devices.



3

2. According to the tips on APP, keep pressing networking button, green LED flash quickly, tips appear on APP, green LED keep on for 3 seconds, network success,

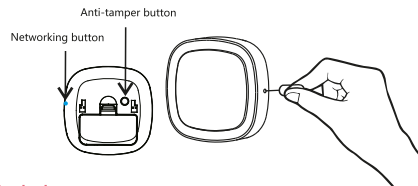

Delete device

In the application, click and hold the selected device, the "delete device" command will be displayed. After removed it, disconnect the network connection device by pressing and holding the pairing button. 6-fold LED blink in green means disconnection of the sensor network from the HUB.

8

LED indicator instruction of devices

Add network	Pressing network button for 2-5s, green LED flash (twice per second)
Quit network	Green LED flash six times (once per second)
Alarm	Red LED flash one time

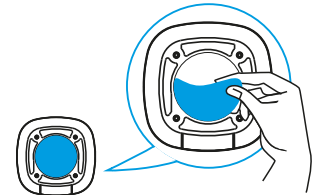

- Paste device in the area required after removing double-side tap on the back side.

9

4

2

1. Ferguson Sp. z o.o. is not responsible for damages caused by improper use of the Ferguson Smart Home system.
2. Batteries attached to the device are not an integral part and not a subject to complaint. The manufacturer is not responsible for their proper operation.
3. Declared wireless ZigBee network's range is based on laboratory tests and applies to open space, keep in mind that the materials used in the construction of houses and flats, wall thickness and conditions of electromagnetic fields can cause a significant reduction in network coverage.

Your product contains batteries covered by the European Directive 2006/66/EC, which cannot be disposed with normal household waste. Please inform yourself about the local rules on separate collection of batteries because correct disposal helps to prevent negative consequences for the environmental and human health.



FERGUSON
Smart Home

Download app: **Ferguson Smart**



* this device requires Ferguson Smart Hub unit to work, not included.

- Please change the battery according to negative and positive of the battery,
- Please deal with waste batteries correctly for environmental protection.



Open the cover to change Battery

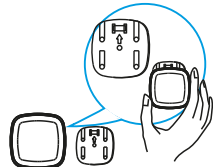

- Note: Please keep arrow part in the picture upwards. Put the detector into the bracket.

Detector Bracket

FERGUSON
Smart Home
intelligent home solutions don't have to be expensive



More info
www.ferguson-digital.eu
and
wiki.ferguson.pl/en
Thanks!