

User Manual



*Please read the user manual carefully before operation



This Smart Combustible Gas Sensor adopts super low power consumption ZigBee wireless module. Used for detecting combustible gas leakage and preventing danger caused by gas leakage. It also can be used as ZigBee repeater to extend wireless transmission distance. Adopts high stability semi-conductor gas sensor, support sensor high stability, little sensitivity drift and may have other features. Sensor alarms while gas density in air exceed alarm level. It is applicable for kitchen or possible gas leakage in indoor area.

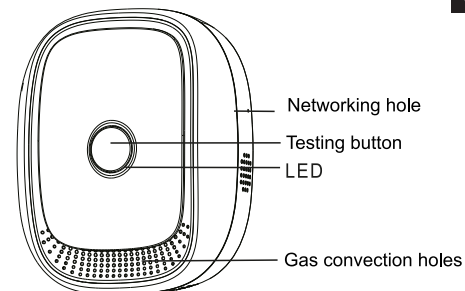

1. Working Voltage : AC100V~240V
2. Average consumption : < 1.5W
3. Alarm sound : 75dB (1 meter distance)
4. Alarm density : 6%LEL±3%LEL(natural gas)
5. Networking : ZigBee HA 1.2
6. Wireless networking distance : < 100m(open area)
7. Working environment : -10°C ~ +50°C ;
8. Working humidity: ≤ 95% RH
9. Dimension: 79* 68* 31mm(not including plug)

1. Shell surface will be slightly hot while working, which is a normal.
2. Please dismantle sensor while decorating house.
3. Avoid spraying aerosol around sensor.
4. Oil adhesion around gas convection holes may effect the sensitivity of gas sensor after long time using. We suggest to users to clear gas convection holes with brush mixing little detergent every 3 months (or based on specific oil pollution level). Avoid letting detergent enter sensor body. Please retest after clean.
5. Semi-conductor of gas sensor supports 5-year lifespan, please replace sensor regularly.
6. Please do not use lighter to test sensor directly in case of any damage to gas sensor inside.
7. For your safety, in addition to use sensor properly, please be vigilant and enhance safety prevention awareness in daily life.

For Natural gas, the sensor should be installed at 0.3-1m below a ceiling, and semi-diameter to gas source less then 1.5m.

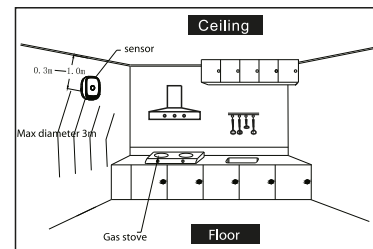

Starting up

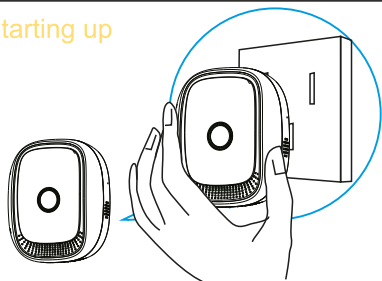

- Insert the sensor into socket and enter Ad Hoc Network condition. Tips will be show on APP, networking successfully.

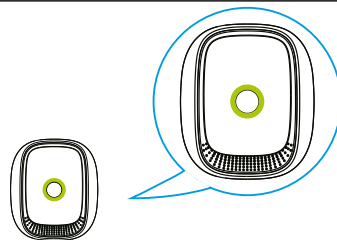

- The green LED lights up after turning on the sensor. When a "beep" sound once the sensor enters into warm-up state. Then red LED and yellow LED flash alternately. Eventually the flash stops 3 minutes later, which indicates that the sensor has entered into normal working state (do not use gas to test when sensor is warming up).

Adding sample device

Select the Smart Hub from the list of devices to which you want to add a new device (sensor) or device with factory settings restored.

1. Click add devices on APP, entering networking mode.



When the LED in the control panel blinks blue, confirm and go to pairing devices.

2. According to the tips on APP, keep pressing networking button, then green LED flashes quickly. Tips appear on APP. Green LED keep on for 3 seconds, Connection is successful.

Example of device:

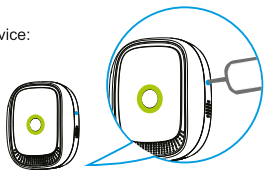

Delete device

In the application, click and hold the selected device, the "delete device" command will be displayed. After removed it, disconnect the network connection device by pressing and holding the pairing button. 6-fold LED blink in green means disconnection of the sensor network from the HUB.

Light states

Product Test

State	Color	Light	Alarm sound
Power	●	Normally on	No
Alarm	●	Flashing	Alarm
Malfunction	●	Normally on	long buzzing

Test button of this sensor is used for testing whether LED indicator and buzzer can work properly. Red LED and yellow LED flashing alternatively with buzzer alarming when press test button.

The sensor will keep alarming while the natural gas density in air exceeds the alarm level. Pls take actions as below:

- 1.Shut down the tube valve right away.
- 2.Extinguish all fire sources and do not use anything can make fire, e.g. lighters, matches., etc.
- 3.Avoid switching on various electric equipments.
- 4.Open the window and make the air flow rapidly.

Symptom	Reason	Remedy
Always warning up after power on(LED keeps flashing)	1. Long time no power; 2. Test gas detector while warming up.	1. Power on detector for 24 hours (aging process); 2. Do not test detectors while warming up.
Yellow LED keeps on and buzzer keeps beeping	Gas sensor fault	Contact dealer to repair



Download app: Ferguson Smart



* this device requires Ferguson Smart Hub unit to work, not included.

1. Ferguson Sp. z o.o. is not responsible for damages caused by improper use of the Ferguson Smart Home system.
2. Batteries attached to the device are not an integral part and not a subject to complaint. The manufacturer is not responsible for their proper operation.
3. Declared wireless ZigBee network's range is based on laboratory tests and applies to open space, keep in mind that the materials used in the construction of houses and flats, wall thickness and conditions of electromagnetic fields can cause a significant reduction in network coverage.



Safety



intelligent home solutions don't have to be expensive



More info at
ferguson-digital.eu
 and
wiki.ferguson.pl/en

Thanks!