

55 mm

55 mm

55 mm

55 mm

55 mm

55 mm

55 mm

55 mm

Temperature and humidity sensor

FS2HT-LCD



Please read the user manual before operating the device.

01

Product information

This smart sensor uses a high-precision detector to determine the current temperature and humidity levels in real time. Thanks to the LCD display, the user has an immediate view of the conditions in the room. The sensor is equipped with wireless communication using the Zigbee protocol, which is characterized by very low power consumption. Data sent via the Smart Hub (sold separately) can be read in the mobile application. This product is suitable for environmental monitoring in residential building, office building, computer room, shopping mall, hotel, teaching building, bank, library, warehouse, etc. The sensor is designed for indoor use.

Sensor construction

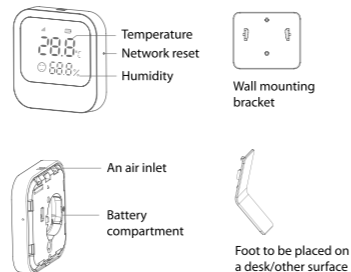

02

Specification

1. Supply voltage: DC3V (1 CR2450 battery)
2. Communication: Zigbee 3.0
3. Communication range: ≤ 100m (in open space)
4. Temperature range: -10°C ~ +55°C
5. Humidity range: ≤ 95%RH (non-condensing)
6. Dimensions: 60x60x14mm

03

Battery change

1. Turn the knob with a screwdriver from the "⊕" position to the "⊖" position.
2. Open the bottom cover with a screwdriver.

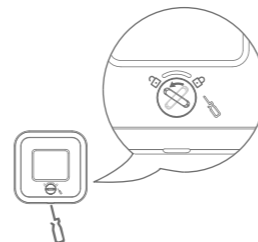

04

3. Place the new battery according to the (+) (-) marks in the battery compartment. Please dispose of the used battery properly to protect the environment.
4. Put the bottom cover back on the device and turn the knob with a screwdriver.

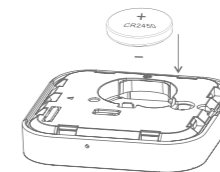

05

Pairing the device

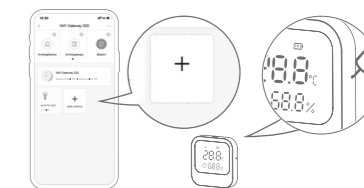

Open the application and enter the Smart Hub settings. Press „+“ to add temperature and humidity sensor. Follow the instructions in the app.

06

55 mm

1. Open the app and enter the gateway by pressing the gear button, then tap "add new sensor" on the "sensors" tab to add a temperature and humidity sensor.
2. Select "other sensors" and then "start pairing".
3. According to the APP instruction, press and hold the pairing button with a pin for 5 seconds. The device will enter the network connecting state and the network icon will flash rapidly (5 times per second). After connecting to the network, the network icon will be lit continuously and the control panel will confirm this with a beep.

The connection process will be stopped if it fails to connect to the network within 60 seconds. The network icon will turn off and the app will display an error.

07

Ferguson Home application



08

Sensor indications

1. Network status icon

Network icon	Status
	1. Flashes during the pairing process.
	2. Stays on if the device is successfully paired.
	3. Flashes slowly 6 times for about 3 seconds (twice/second) if pairing failed.

2. Battery power icon



3. Graphic designation of environmental conditions

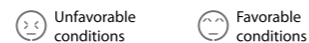

09

Installation

Wall mounting

1. Insert the wall mount into the bottom of the device cover.
2. Tear off the adhesive film, stick the device in the required position.

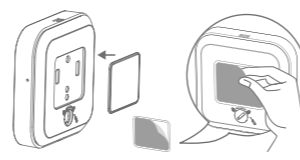

10

When installing with double-sided tape, pay attention to the following:

1. Make sure the installation surface is smooth, flat, stable, dry and clean.
2. After installation, regularly check whether the product is firmly attached to the installation surface.

Desk/other surface foot

1. Insert the desktop foot into the bottom cover of the device.
2. Place the device on a flat and dust-free surface.



11

Safety

1. Ferguson Sp. z o.o. does not take responsibility for damages resulting from improper use of the Ferguson Smart Home system.
2. The batteries attached to the devices are not their integral part, they are not subject to complaint and the manufacturer is not responsible for their incorrect operation.
3. The declared range of the ZigBee network is based on laboratory tests and applies to open spaces, it should be remembered that the materials used to build houses and apartments, wall thickness and electromagnetic field conditions may significantly reduce the network range.

The product contains batteries covered by Directive 2006/66/EC, which cannot be disposed of with normal household waste. Please check your local regulations on disposal of batteries, as proper disposal helps prevent environmental pollution and damage to health.



Simplified declaration of conformity

Importer: Ferguson Sp. z o.o.
ul. Dworska 1, 61-619 Poznań

Name: Ferguson FS2HT-LCD

Device type: Humidity and temperature sensor with LCD display

The above-mentioned product complies with Directive 2014/53/EU of the European Parliament and of the Council of 16 April 2014 on the harmonization of the laws of the Member States concerning the making available on the market of radio equipment and repealing Directive 1999/5/EC.

Full Declaration of Conformity for download at:
<https://ferguson-digital.eu/declarations-of-conformity/>

13